

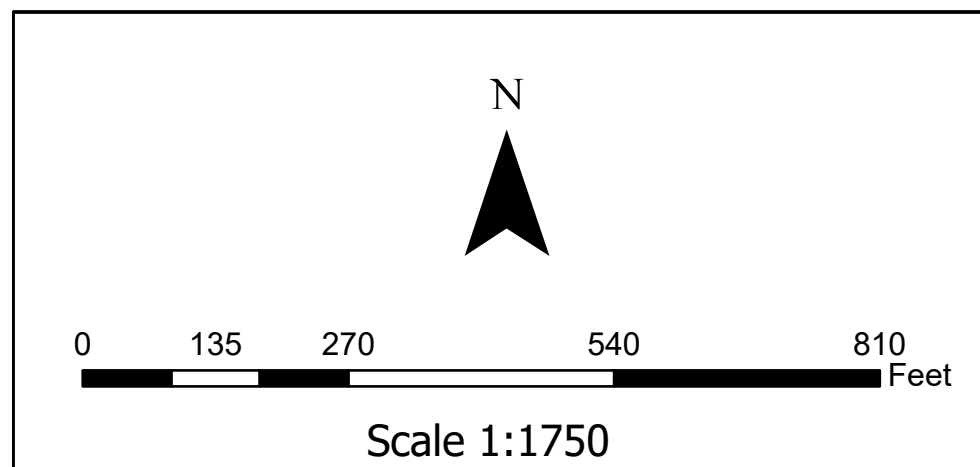

Maxar, Microsoft, Esri Community Maps contributors, City of Aurora, CO, County and City of Denver, County of Arapahoe, © OpenStreetMap contributors, Esri, HERE, Garmin, SafeGraph, GeoTechnologies, Inc., METI/NASA-USGS, EPA, Esri, DeLorme, NAVTEQ, Swatchbourn, USA



Brightview Maintenance Areas

- Sod Areas - Edge - 13 times per year (monthly)
 Aerate - 1 time per year
- Native Areas - Mow - 1 time per year
 Weed Control - 1 time per year
- Pet Station - Waste Removal/Bag Replacement - 52 times per year (weekly)
- Sky Ranch Parcel

PURE CYCLE CORPORATION
 34501 E QUINCY AVE, BLDG 34
 WATKINS, COLORADO 80137

A WATER AND WASTEWATER SERVICES COMPANY
 PH: 303-292-3456 WWW.PURECYCLEWATER.COM

CREATED:	COLIN BROWN
DATE:	6/10/2022
DATA:	COLIN BROWN
DATA:	R. LOPEZ
DATA:	B. BROUILLARD
DATA:	KT ENGINEERING
DATA:	